



Luxurious Resort Living
Fully Loaded Apartments



Awarded in 2020 as
“Lifestyle
Property
of the Year”
-By Franchise India

MAPSKO 

MOUNT VILLE

Sector-79, Gurgaon

HRERA registered 328 of 2017 dated 23/10/2017

Bring Home the Mountains



Awarded in 2020 as
“Residential
Project of the
Year”
-By Realty+



Awarded in 2014 as
Asia's Best Real
Estate Property to
look out for
-By E&Y



Regd. Office:
Ground, 1264, Sector 21, Gurgaon -122016 , HR, IN
Mobile No. +91 9990666747
Branch Office:
Shop No. 0004, Svh 83 Metro Street, Sector 83, Gurugram -122003, HR, IN
www.realtyventuresindia.com



Get Inspired everyday with Aravali's splendour

The Aravali range is one of the world's oldest mountain ranges. Its northern end continues into Haryana and ends in Delhi at Raisina Hill as its last extension. Despite erosion over time the hills are no less than a source of eternal beauty and a matter of everyday inspiration for beholders. Its panoramic view, greenery and healthy environmental effects make it a special feature of Mount Ville.

Bring home the

mountains...



Actual Image

READY TO MOVE IN

Luxurious Resort Living Residences

Hafeez Contractor is India's most celebrated architect. He is known for creating marvels but, in creating the blueprint of Mount Ville, his genius has tried to compete with the height and beauty of overlooking hill range. Whether exterior or interior, every inch of architectural magic, strewn in apartments and terrace homes totaling 756 apartments decorating 8 high-rise towers, is amazingly impeccable and ideal for royal living.

Spread over 16.5 acres of land | Elevated complex on green belt | Apartments ranging from 1490 sq. ft. to 2650 sq. ft. Terrace homes ranging from 1620 sq. ft. to 2710 sq.ft



Actual Image



Landscape
Designed by
LSG INC. USA

*A perfect
compliment to
majestic Aravalis*

The abundance of green, pathways, amphitheatre, lawns, and most sustainable ratio of open space versus built-up space make Mount Ville a unique treat of urban living. The breathtaking landscaping plan has been masterfully prepared by world's leading landscape architectures – LSG Inc, USA.

**Terrace lawn | Pergola seating | Senior citizen area | Stage & seating area | Artwork / Sculpture
Children's play area**

Actual Images



Drawing Room



Tower Entrance Lobby



Lift Lobby



Bedroom

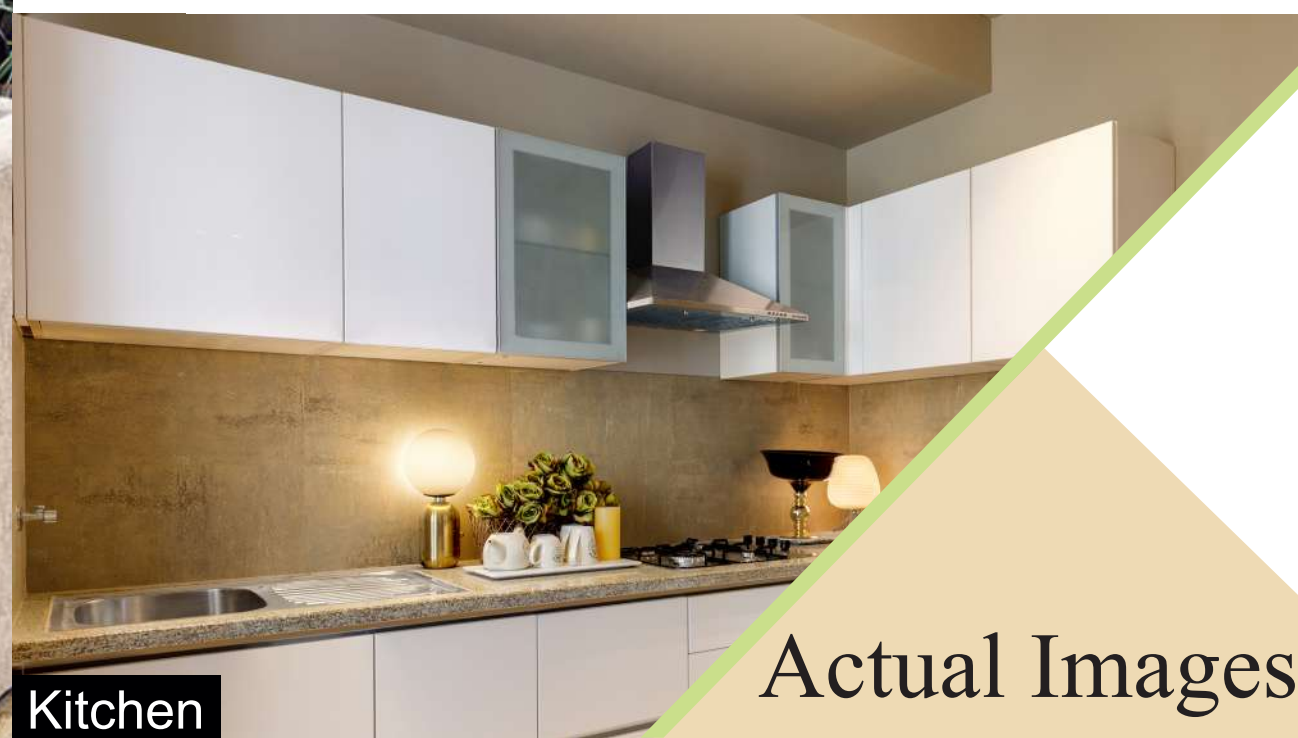

Kitchen

Fully Loaded Apartments with Kitchen, Wardrobes & AC s

Pampering four-walls to inspire all

Inundated with sunlight and cross currents of refreshing breeze, the spacious Drawing room is ever ready to welcome you and your guests. The sprawling and cosy bedrooms give the cherished confinement with promise of desired comfort. Whether the solitary room of children's study, ideally located kitchen for the lady of the house, or balconies that offer mountain view while you relax over a cup of tea, every apartment of Mount Ville adds value to inspired living.

**3-4 Bedrooms premium hill view apartments
Modular kitchen with chimney and hob |
Spacious Balconies**

Actual Images

Exclusive Club



A paradise for fitness & Leisure enthusiasts

Health is wealth. With the rising awareness, observing a regimen of sports has rather become a part of lifestyle. Some play a racquet game, some ball sport and some simply jog or walk. Mount Ville facilitates high standard of sports facilities within its campus where luxurious living is amply buttressed by a wide range of recreational features.

**Gymnasium | Tennis court | Skating rink
Outdoor fitness node | Badminton court**

Actual Images

This is an artistic impression - Mount Ville

Swimming Pool



Kids Swimming Pool

Different strokes of swimming

Swimming and water sports make an integral part of today's inspired lifestyle. Going for a spirited dive and splashing a few strokes in the blue waters of swimming pool is joy for children and a rejuvenating work out for seniors. Keeping in mind different choices of different age group, Mount Ville has a variety of well-built pools; not merely for sake of them, but to ensure that luxury is not watered down even if it's about water bodies.

Adult pool | Children's pool | Interactive water feature | Water feature

Actual Images



Terrace



Basketball Court



Kids Play Area



Open Gym



Jogging Track & Pergola Seating

Actual Images

Dazzling Legends for enriching lifestyle

Entry | Exit | Water Feature | Pergola Screening at Ramp | Tennis and Multiple Purpose Court | Drop-Off Points | Gazebo | Children's Play Area | Adult Pool | Pergola Water Feature | Green Terraced Lawn | Senior Citizens Seating Space | Stage and Seating Area | Multipurpose Court | Amphitheatre Seating | Multipurpose Lawn Space | Jogging Track | Skating Court | Outdoor Fitness Space

LEGEND

- 1 ENTRY GATE 1
- 2 ENTRY GATE 2
- 3 SECURITY CABIN
- 4 ADULT POOL
- 5 KIDS POOL
- 6 SPLASH PAD
- 7 KIDS PLAY AREA
- 8 GAZEBO/SEATING AREA
- 9 FOOTBALL PLAY AREA
- 10 WATER FEATURE PERGOLA
- 11 HALF BASKETBALL COURT
- 12 CENTRAL GREEN PARK
- 13 YOGA AND MEDITATION LAWN
- 14 WATER FEATURE
- 15 BADMINTON COURT
- 16 SKATING RINK
- 17 OUTDOOR GYM
- 18 DROP OFF
- 19 TENNIS COURT
- 20 STAGE + SEATING
- 21 FLAG POLE
- 22 RAMP
- 23 CRICKET PITCH
- 24 JOGGING TRACK /PATHWAY
- 25 CLUB AMENTIES

- BANQUET HALL
- SQUASH COURT
- GUEST ROOMS
- PROVISION FOR BAR AND RESTAURANT

* -FUTURE DEVELOPMENT

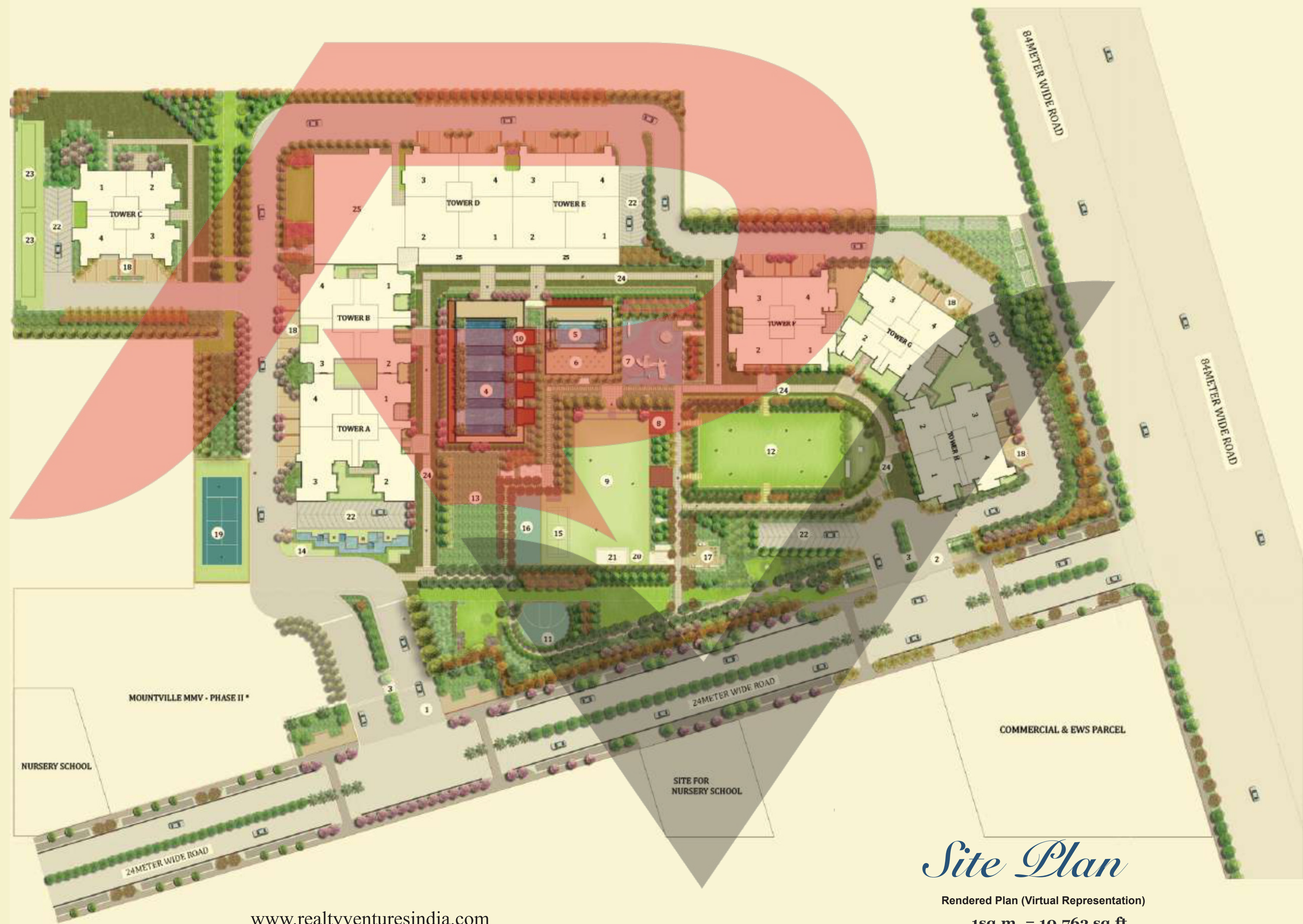

Specifications

AIR CONDITIONING	Split AC's of Daikin in all Bedrooms and Living room	ELECTRICAL	<ul style="list-style-type: none"> • Modular switches of Honeywell. • Copper Electrical wiring throughout in concealed conduit with provisions for Light point, Power point, TV & Phone Sockets with protective MCBs of Honeywell. • Minimum 5 KVA power back up to be provided in each apartment. 		
LIVING, DINING & LOBBY/PASSAGE Floor Walls	Imported marble Zip Plast with Plastic paint of pleasing shades				
BEDROOMS Floor Walls Fitting / Fixtures	Premium Action Tesa Laminated Wooden Flooring in all Bedrooms. Zip Plast with plastic paint of pleasing shades. Wardrobes of Spacewood in all Bedrooms.			FACADE	Texture Finish
BEDROOMS Floor Walls Fitting / Fixtures	Premium Action Tesa Laminated Wooden Flooring in all Bedrooms. Zip Plast with plastic paint of pleasing shades. Wardrobes of Spacewood in all Bedrooms.			CLUB FACILITY	Kids swimming pool Gymnasium Steam sauna and spa Indoor gaming zone Movie Theatre Cafe & restaurant Saloon Business centre and work stations Conference room & library Meeting rooms Crèche Multipurpose room for Zumba aerobics & yoga
BALCONIES Floor Walls	Terrazzo / Ceramic Tiles Permanent Paint Finish			OTHER AMENITIES	Exclusive landscape Swimming Pool Kids splash pad Lawn tennis court Senior citizen area Badminton court Cricket pitches Half basketball court Banquet hall Guest rooms Squash court Football play area Toddlers play area Open gym Skating rink Gazebos / Pergolas Fruit forest Over 2 lacs trees shrubs & bushes Amphitheatre double basement car parking Water features Lush green surroundings Well-lit walkway and jogging track
KITCHEN Walls Floor Counter Fittings / Fixtures	Ceramic Tiles up to 2 feet above counter & Plastic paint in balance area Antiskid Ceramic Tiles Granite <ul style="list-style-type: none"> • Spacewood Modular Kitchen with Faber - Chimney and hob, • Gas Pipeline, • CP fittings of Kohler • Franke SS Single bowl Sink with drain board. 				
TOILETS (Except Servant's Toilet) Walls Floor Counter Fittings/Fixtures	Ceramic tiles up to 7'0" height Antiskid Ceramic Tiles Granite CP fittings, WC & Wash Basin of Kohler, Mirror.				
SERVANT ROOM Floor Walls	Terrazzo / Ceramic Tiles Acrylic Emulsion paint.				
DOORS Internal Entrance Door External Doors & Windows	Seasoned Hardwood frames with moulded skin shutters Teak Veneered & Polished shutter UPVC of Deceuninck				
ENTRANCE LOBBY	Air-Conditioned double height entrance lobby with lounge and 3 high speed Kone elevators				
SECURITY SYSTEM / FIRE FIGHTING SYSTEM	3 tier security system, gated community and CCTV in common areas. Firefighting system.				

Windows to Luxury



Lifestyle Property
of the Year
- by Franchise India



Residential Project
of the Year
- by Realty+



Double Height
AC Entrance
Lobby on ground
at every tower



3 Sprawling
Golf Courses
Near by

Exemplary
Architecture
by
Hafeez
Contractor



Beautiful
Landscape
Designed by
LSG INC.
USA



Double Height
Still for more
Greenery &
Open Space



Exclusive
Terrace Homes



Fully AC
Apartments



3 Lifts in
Each Tower

Imported
Marbles in
Living Area



Stylish
Modular
Wardrobe For
Chic Robes



Modular
Kitchen with
Chimney &
Gas Pipe Line



Attractive
Location
Feasibility

- Just 2 min drive away from NH-8
- 5 min drive from Golf Course Extn. Road / Sohna Road
- 2 min drive from SPR



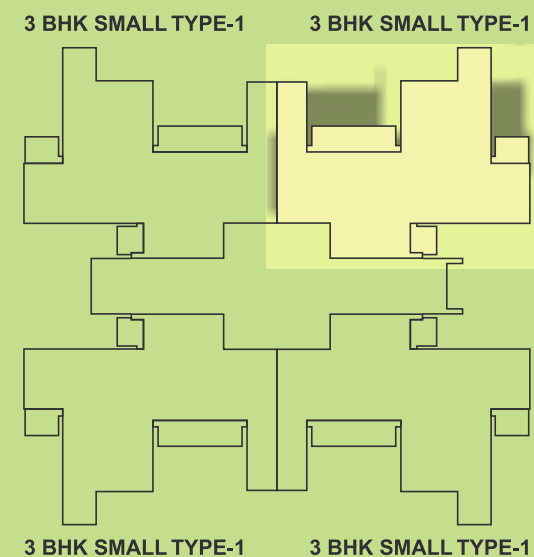

TYPE 1 -
 Reference Area: 1490 sq. ft. 3BHK + 3T
 Carpet Area: 862.18 ~ 865.52 sq.ft.
 Balcony Area: 136.48 ~ 141.54 sq.ft.
 For Towers C,D,E,F and H

Note: Visual representations shown in this brochure are purely conceptual. All building plans, specifications, layout plans etc. are tentative and subject to variation & modification by the company or the competent authorities sanctioning plans. Brand names appearing in the brochure are for artwork purposes only.
 1sq.m. = 10.763 sq.ft.

Type 1 -
 Reference Area: 1620 sq. ft. 3BHK + 3T + TERRACE
 Carpet Area: 862.18 ~ 865.52 sq.ft.
 Balcony Area: 280.6 ~ 285.88 sq.ft.
 Towers C,D,E,F and H

Note: Visual representations shown in this brochure are purely conceptual. All building plans, specifications, layout plans etc. are tentative and subject to variation & modification by the company or the competent authorities sanctioning plans. Brand names appearing in the brochure are for artwork purposes only.
 1sq.m. = 10.763 sq.ft.

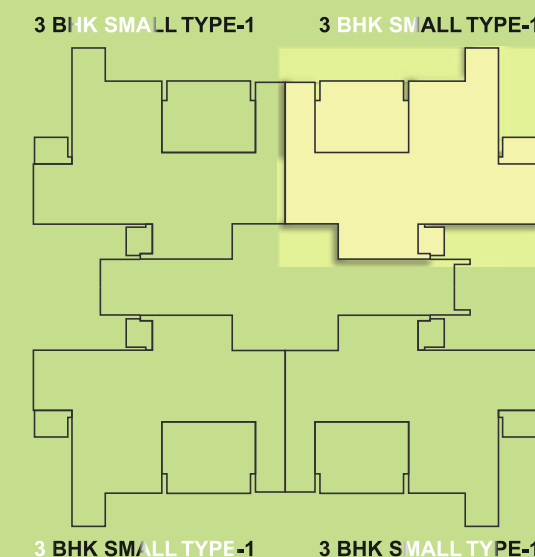

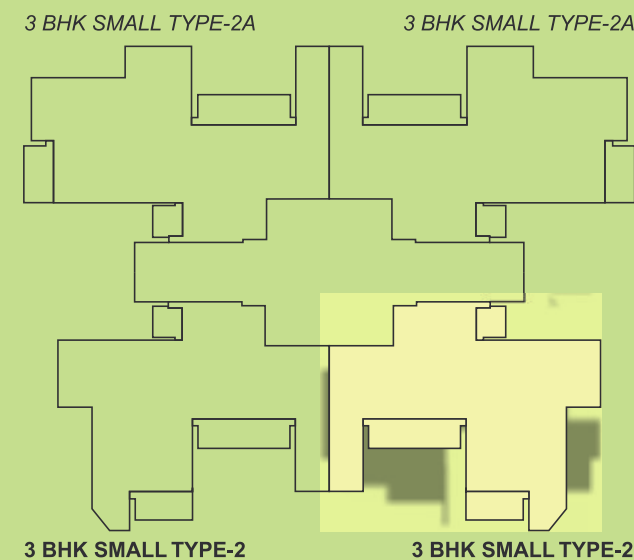

TYPE 2 -
 Reference Area: 1510 sq. ft. 3BHK + 3T
 Carpet Area: 862.18 sq.ft
 Balcony Area: 158.87 sq.ft
 For Tower G Front Units

Note: Visual representations shown in this brochure are purely conceptual. All building plans, specifications, layout plans etc. are tentative and subject to variation & modification by the company or the competent authorities sanctioning plans. Brand names appearing in the brochure are for artwork purposes only.
 1sq.m. = 10.763 sq.ft.

TYPE 2 -
 Reference Area: 1620 sq. ft. 3BHK + 3T + Terrace
 Carpet Area: 862.18 sq.ft.
 Balcony Area: 285.99 sq.ft.
 Tower G Front Unit

Note: Visual representations shown in this brochure are purely conceptual. All building plans, specifications, layout plans etc. are tentative and subject to variation & modification by the company or the competent authorities sanctioning plans. Brand names appearing in the brochure are for artwork purposes only.
 1sq.m. = 10.763 sq.ft.

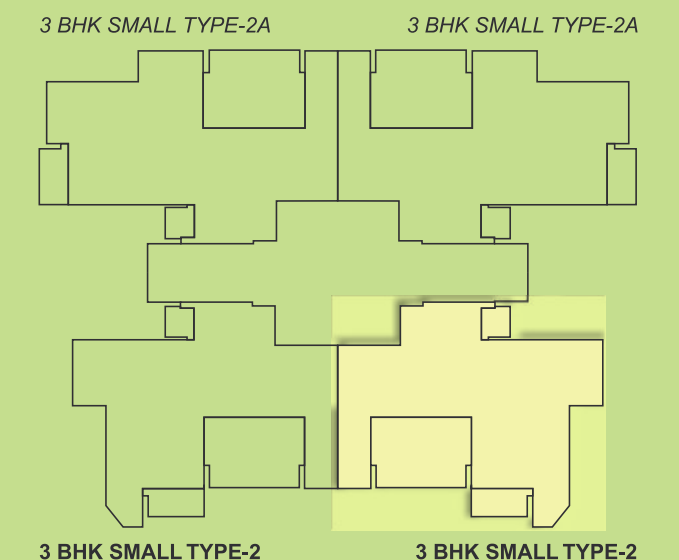

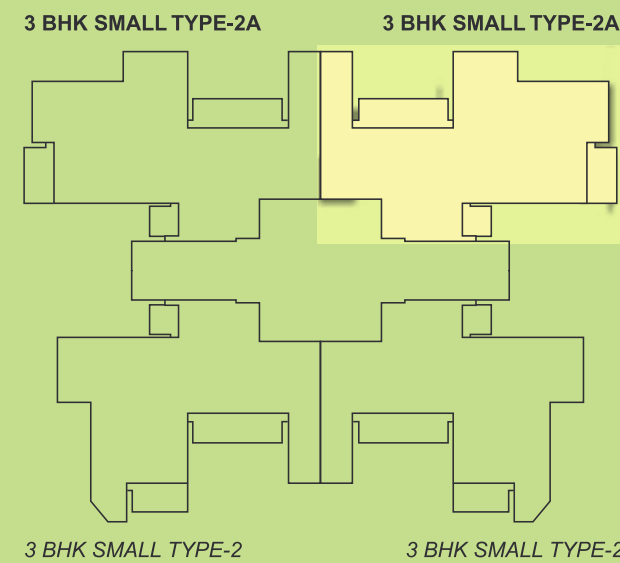

TYPE 2A -

Reference Area: 1510 sq. ft. 3BHK + 3T
 Carpet Area: 867.24 sq.ft.
 Balcony Area: 158.87 sq.ft.
 Tower G Back Units

Note: Visual representations shown in this brochure are purely conceptual. All building plans, specifications, layout plans etc. are tentative and subject to variation & modification by the company or the competent authorities sanctioning plans. Brand names appearing in the brochure are for artwork purposes only.
 1sq.m. = 10.763 sq.ft.

TYPE 2A -

Reference Area: 1620 sq. ft. 3BHK + 3T + TERRACE
 Carpet Area: 867.24 sq.ft.
 Balcony Area: 303.1 sq.ft.
 Tower G Back Units

Note: Visual representations shown in this brochure are purely conceptual. All building plans, specifications, layout plans etc. are tentative and subject to variation & modification by the company or the competent authorities sanctioning plans. Brand names appearing in the brochure are for artwork purposes only.
 1sq.m. = 10.763 sq.ft.

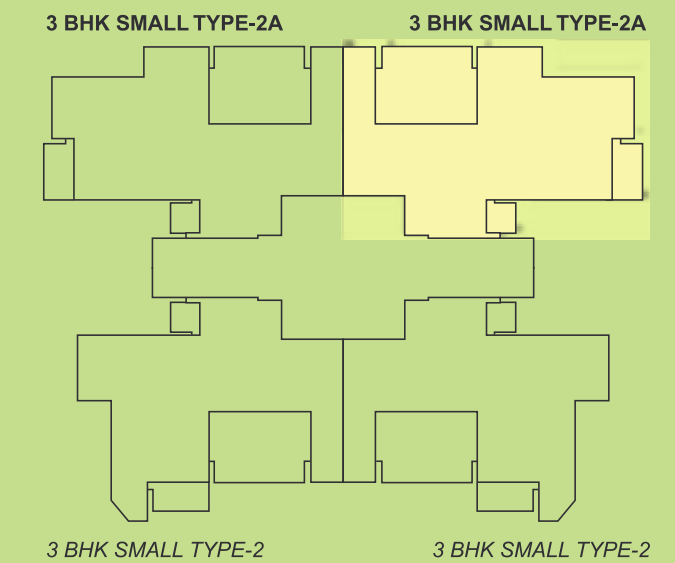

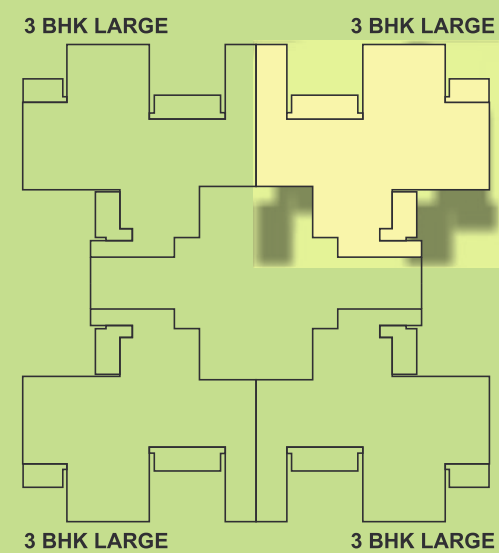

Reference Area: 1815 sq. ft. 3BHK + 3T + SR
 Carpet Area: 1071.33 sq.ft. ~ 1074.23 sq. ft
 Balcony Area: 167.27 sq.ft. ~ 167.70 sq.ft.
 Tower B and A (1 and 4 Units)

Note: Visual representations shown in this brochure are purely conceptual. All building plans, specifications, layout plans etc. are tentative and subject to variation & modification by the company or the competent authorities sanctioning plans. Brand names appearing in the brochure are for artwork purposes only.
 1sq.m. = 10.763 sq.ft.

Reference Area: 1960 sq. ft. 3BHK + 3T + SR + TERRACE
 Carpet Area: 1071.33 sq.ft. ~ 1074.23 sq. ft
 Balcony Area: 326.46 sq.ft.
 Tower B and A (1 and 4 Units)

Note: Visual representations shown in this brochure are purely conceptual. All building plans, specifications, layout plans etc. are tentative and subject to variation & modification by the company or the competent authorities sanctioning plans. Brand names appearing in the brochure are for artwork purposes only.
 1sq.m. = 10.763 sq.ft.

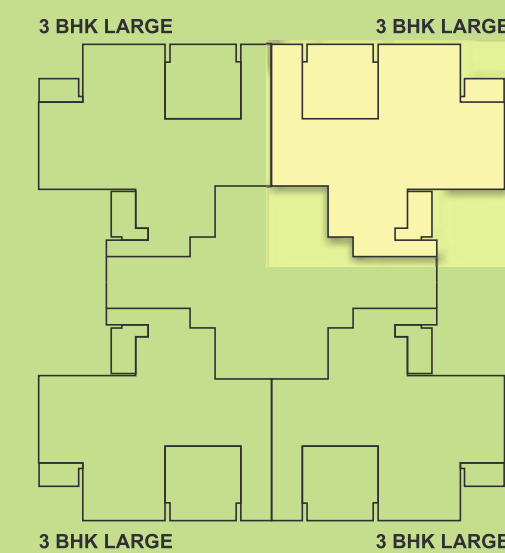

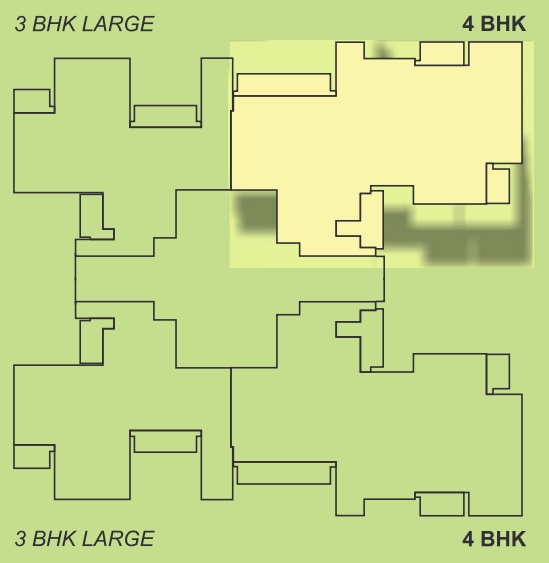

Reference Area: 2650 sq. ft. 4BHK + 4T + SR
 Carpet Area: 1687.99 sq.ft.
 Balcony Area: 276.74 sq.ft.
 Tower A (2 and 3 Units)

Note: Visual representations shown in this brochure are purely conceptual. All building plans, specifications, layout plans etc. are tentative and subject to variation & modification by the company or the competent authorities sanctioning plans. Brand names appearing in the brochure are for artwork purposes only.
 1sq.m. = 10.763 sq.ft.

Reference Area: 2710 sq. ft. 4BHK + 4T + SR + TERRACE
 Carpet Area: 1687.99 sq.ft.
 Balcony Area: 350.36 sq.ft.
 Tower A (2 and 3 Units)

Note: Visual representations shown in this brochure are purely conceptual. All building plans, specifications, layout plans etc. are tentative and subject to variation & modification by the company or the competent authorities sanctioning plans. Brand names appearing in the brochure are for artwork purposes only.
 1sq.m. = 10.763 sq.ft.

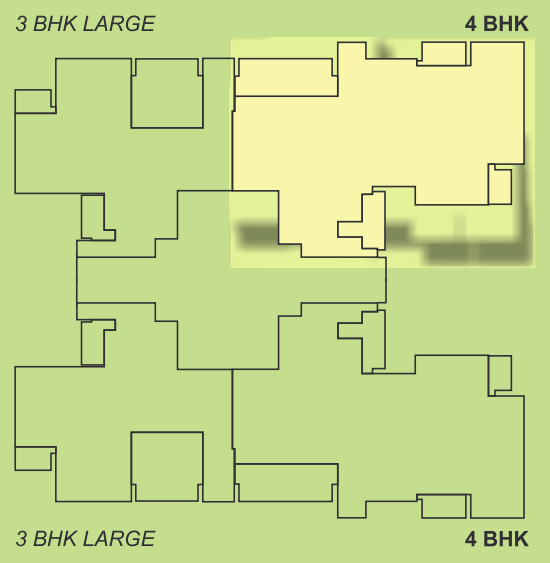



MAPSKO
Casa Bella
 Sector-82, Gurgaon

956 Units
 APARTMENTS | VILLAS
 PENTHOUSES



MAPSKO
Garden Estate
 Sector-26, 26A & 27 Sonapat

Approximately 150 Acres
 INTEGRATED TOWNSHIP

This is an artistic impression



MAPSKO
Royale Ville
 Sector-82, Gurgaon

486 Units
 3-4-5 BHK LUXURY APARTMENTS



MAPSKO
cityhomes
 Sector-27, Sonapat

486 INDEPENDENT FLOORS
 180 / 250 / 350 sq.yards

This is an artistic impression



MAPSKO
Paradise
 Sector-82, Gurgaon

348 Units
 2-3 BHK APARTMENTS



MAPSKO
Galleria
 Sector-26, 26A & 27 Sonapat

HRERA registered PKL-SNP-72-2018 Dated: 14.12.2018

562 Shops
 COMMERCIAL SPACE

This is an artistic impression

Few Prestigious Projects

Few Prestigious Projects

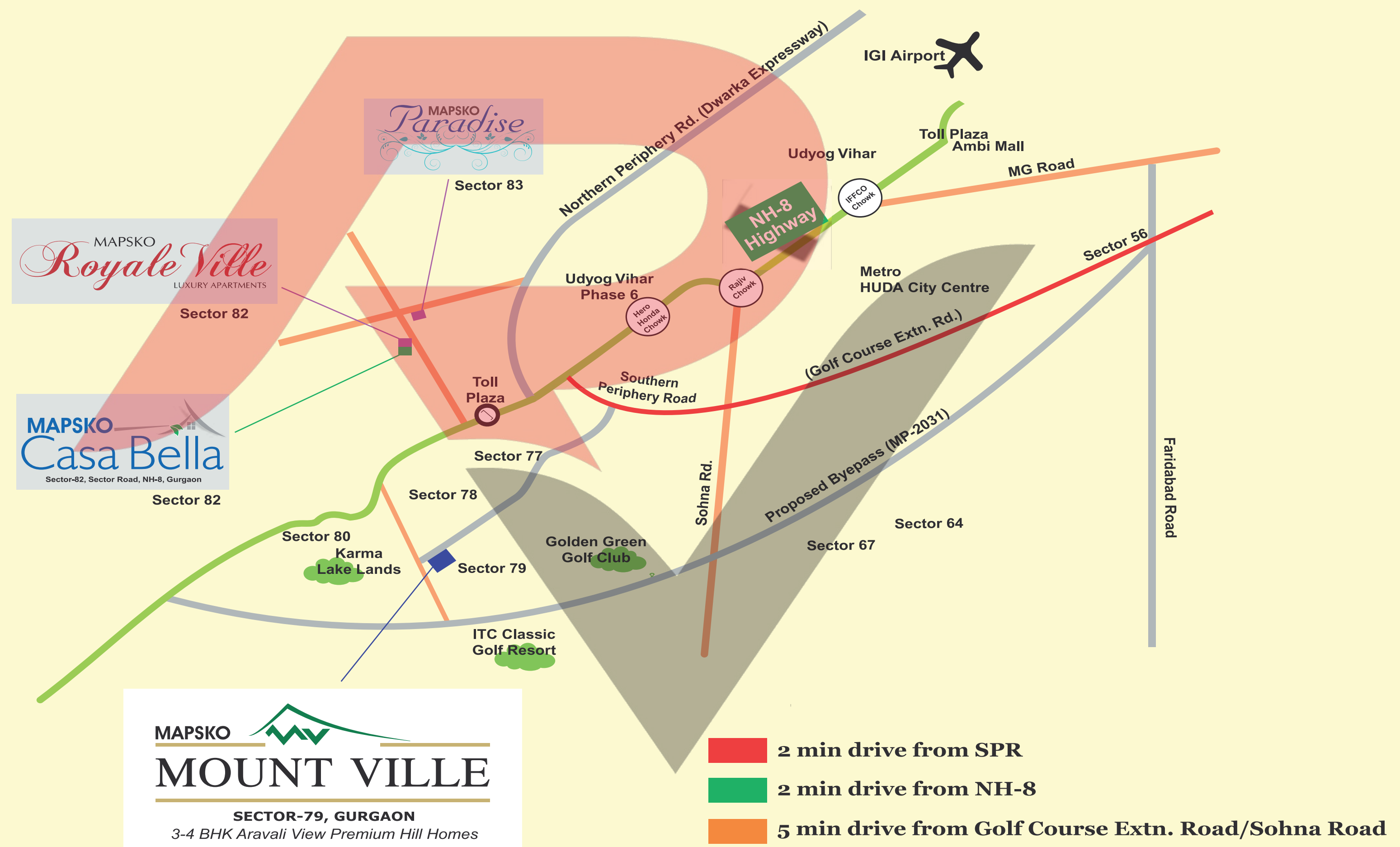

MAPSKO 
MOUNT VILLE
 SECTOR-79, GURGAON
 3-4 BHK Aravali View Premium Hill Homes

HRERA registered 328 of 2017 dated 23/10/2017

* Traveling time depending on traffic conditions
 * Indicative Map not to Scale

Location Map

Gurgaon - The city is icon of rapid development with presence of network of wide roads, expressways, highways and metro, and much in pipeline. Mount Ville at sector 79 is ideally located at the serene foothill of Aravali.