

2 BHK UNIT AND CLUSTER PLAN



SUPER AREA - 1465.0 SQ. FT.

Disclaimer – In the interest of maintaining high standards, all floor plans, areas, dimensions and specifications are indicative and are subject to change till the final completion of the project. (1 sq. Mtr. = 10.764 Sq.Ft. and 1 meter = 3.2808 feet)



3 BHK + Servant Toilet UNIT AND CLUSTER PLAN



SUPER AREA - 1745.0 SQ. FT.

Disclaimer – In the interest of maintaining high standards, all floor plans, areas, dimensions and specifications are indicative and are subject to change till the final completion of the project. (1 sq. Mtr. = 10.764 Sq.Ft. and 1 meter = 3.2808 feet)

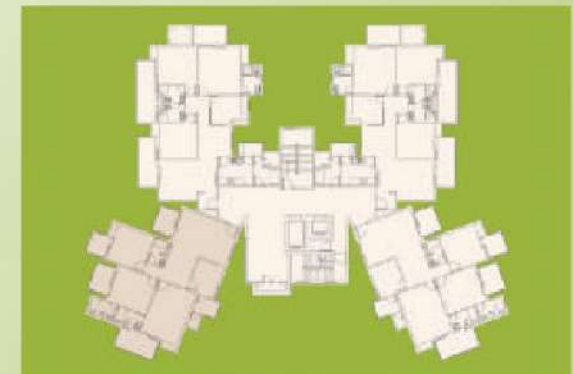

3 BHK + Servant Toilet UNIT AND CLUSTER PLAN



SUPER AREA - 1745.0 SQ. FT.

Disclaimer – In the interest of maintaining high standards, all floor plans, areas, dimensions and specifications are indicative and are subject to change till the final completion of the project. (1 sq. Mtr. = 10.764 Sq.Ft. and 1 meter = 3.2808 feet)



3 BHK + STUDY + Servant Room UNIT AND CLUSTER PLAN



SUPER AREA - 2070.0 SQ. FT.

Disclaimer – In the interest of maintaining high standards, all floor plans, areas, dimensions and specifications are indicative and are subject to change till the final completion of the project. (1 sq. Mtr. = 10.764 Sq.Ft. and 1 meter = 3.2808 feet)

